



# GRAND HOTEL DA VINCI



Modular spaces and solutions



GRAND HOTEL DA VINCI



SALA MONNALISA

SALA BRIGITTE BARDOT

SALA SOFIA LOREN

SALA AUDREY HEPBURN

SALA JULIE ANDREWS

SALA JANE FONDA

SALA MARYLIN

SALA BETTE DAVIS

SALA RITA HAYWORTH

SALA VINCI

# SALA MONNALISA

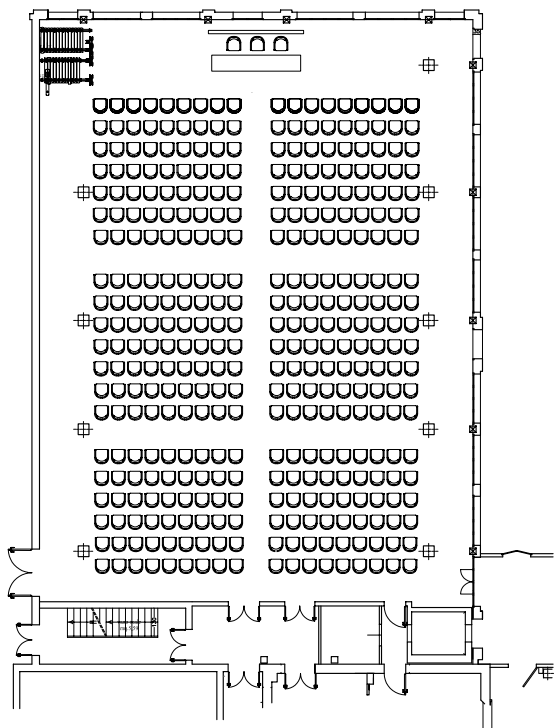

Superficie | *Size*

m<sup>2</sup> 545

Misure | *Measurements*

mt. 27,05x20,15

Altezza | *Height*

mt. 3,50

Piano primo | *1st floor*

Illuminazione naturale | *Daylight*

Platea | *Theatre*

**500** pax

Ferro di cavallo | *U shape*

**100** pax

Tavolo Imperiale | *Boardroom*

**150** pax

Banchi scuola | *Classroom style*

**250** pax

# SALA BRIGITTE BARDOT

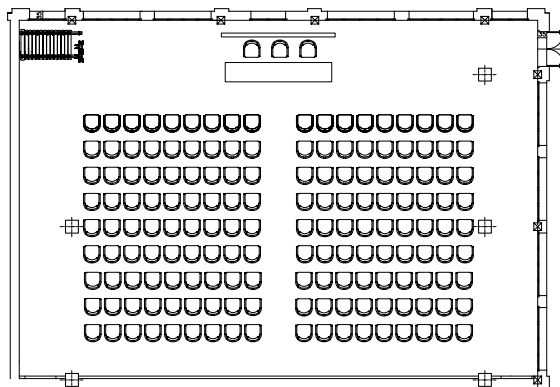

Superficie | *Size*

m<sup>2</sup> 279

Misure | *Measurements*

mt. 20,15x13,83

Altezza | *Height*

mt. 3,50

Piano primo | *1st floor*

Illuminazione naturale | *Daylight*

Platea | *Theatre*

**250** pax

Ferro di cavallo | *U shape*

**55** pax

Tavolo Imperiale | *Boardroom*

**70** pax

Banchi scuola | *Classroom style*

**120** pax

# SALA SOFIA LOREN

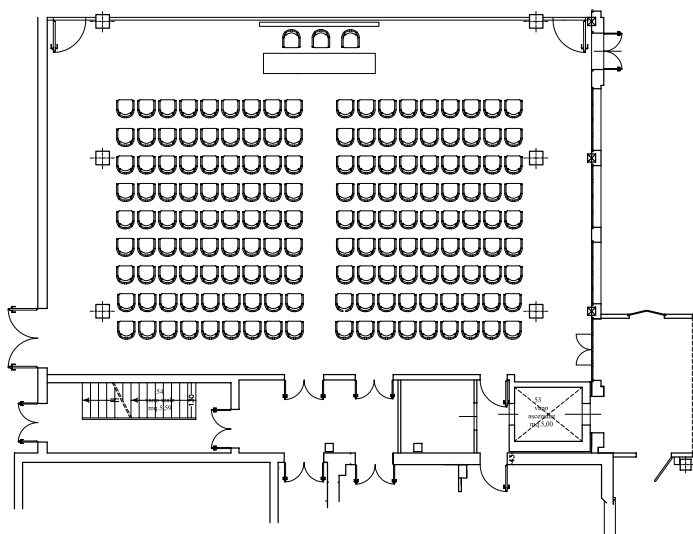

Superficie | *Size*

m<sup>2</sup> 264

Misure | *Measurements*

mt. 20,15x13,12

Altezza | *Height*

mt. 3,50

Piano primo | *1st floor*

Illuminazione naturale | *Daylight*

Platea | *Theatre*

**280** pax

Ferro di cavallo | *U shape*

**60** pax

Tavolo Imperiale | *Boardroom*

**62** pax

Banchi scuola | *Classroom style*

**100** pax

# SALA AUDREY HEPBURN

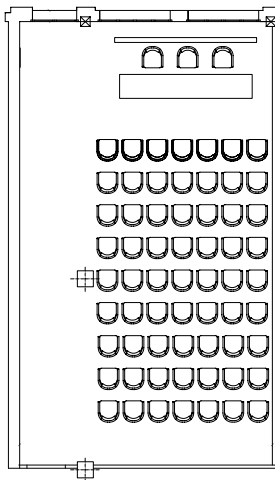

Superficie | *Size*

m<sup>2</sup> 109

Misure | *Measurements*

mt. 13,83x7,88

Altezza | *Height*

mt. 3,50

Piano primo | *1st floor*

Illuminazione naturale | *Daylight*

Platea | *Theatre*

**80** pax

Ferro di cavallo | *U shape*

**36** pax

Tavolo Imperiale | *Boardroom*

**38** pax

Banchi scuola | *Classroom style*

**40** pax

# SALA JULIE ANDREWS

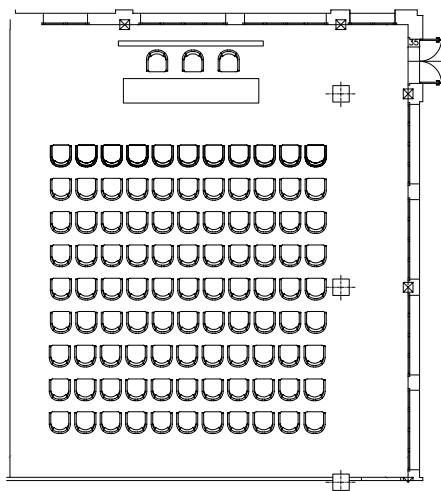

Superficie | *Size*

m<sup>2</sup> 168

Misure | *Measurements*

mt. 13,83x12,17

Altezza | *Height*

mt. 3,50

Piano primo | *1st floor*

Illuminazione naturale | *Daylight*

Platea | *Theatre*

**150** pax

Ferro di cavallo | *U shape*

**32** pax

Tavolo Imperiale | *Boardroom*

**38** pax

Banchi scuola | *Classroom style*

**60** pax

# SALA JANE FONDA

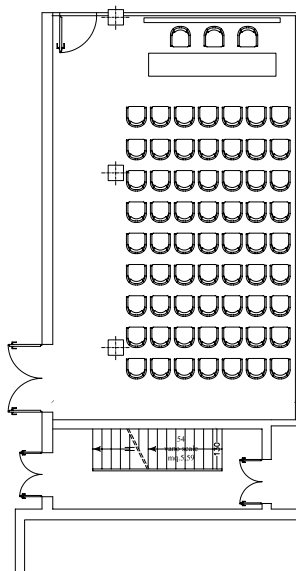

Superficie | *Size*

m<sup>2</sup> 103

Misure | *Measurements*

mt. 13,12x7,88

Altezza | *Height*

mt. 3,50

Piano primo | *1st floor*

Illuminazione naturale | *Daylight*

Platea | *Theatre*

**90** pax

Ferro di cavallo | *U shape*

**24** pax

Tavolo Imperiale | *Boardroom*

**28** pax

Banchi scuola | *Classroom style*

**30** pax



# SALA MARYLIN

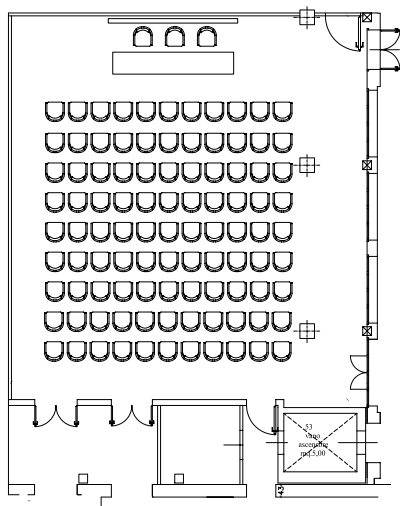

Superficie | *Size*

m<sup>2</sup> 160

Misure | *Measurements*

mt. 13,12x12,17

Altezza | *Height*

mt. 3,50

Piano primo | *1st floor*

Illuminazione naturale | *Daylight*

Platea | *Theatre*

**190** pax

Ferro di cavallo | *U shape*

**40** pax

Tavolo Imperiale | *Boardroom*

**42** pax

Banchi scuola | *Classroom style*

**50** pax

# SALA BETTE DAVIS

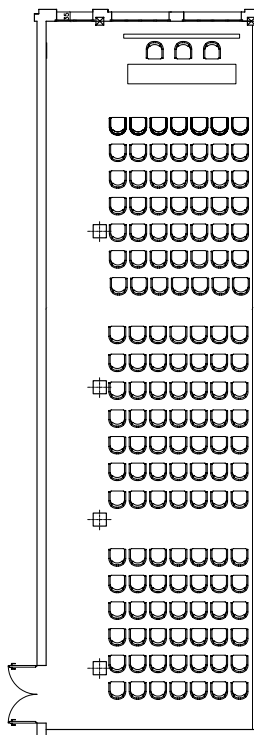

Superficie | *Size*

m<sup>2</sup> 213

Misure | *Measurements*

mt. 27,05x7,88

Altezza | *Height*

mt. 3,50

Piano primo | *1st floor*

Illuminazione naturale | *Daylight*

Platea | *Theatre*

**220** pax

Ferro di cavallo | *U shape*

**45** pax

Tavolo Imperiale | *Boardroom*

**45** pax

Banchi scuola | *Classroom style*

**50** pax

# SALA RITA HAYWORTH

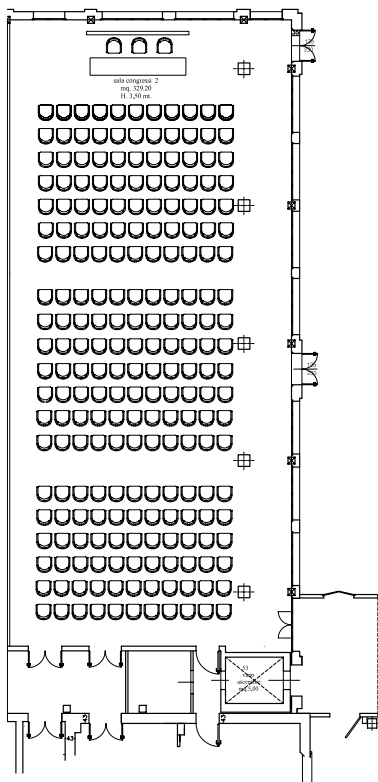

Superficie | *Size*

m<sup>2</sup> 329

Misure | *Measurements*

mt. 27,05x12,17

Altezza | *Height*

mt. 3,50

Piano primo | *1st floor*

Illuminazione naturale | *Daylight*

Platea | *Theatre*

**350** pax

Ferro di cavallo | *U shape*

**60** pax

Tavolo Imperiale | *Boardroom*

**80** pax

Banchi scuola | *Classroom style*

**150** pax

# SALA VINCI

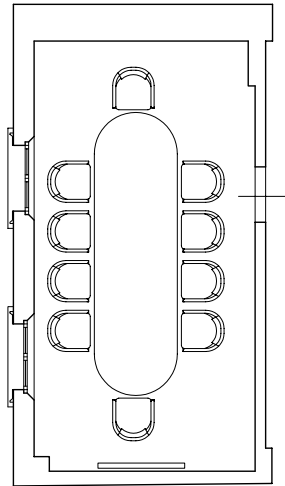

Superficie | *Size*

m<sup>2</sup> 20

Misure | *Measurements*

mt. 6,25x 3,2

Altezza | *Height*

mt. 3,50

Piano primo | *1st floor*

Illuminazione naturale | *Daylight*

Tavolo Imperiale | *Boardroom*

**15** pax



**BATANI**

*Select Hotels*

MICE & EVENTS

BATANI SELECT HOTELS

Viale 2 Giugno, 34 - 48015 Milano Marittima (Ra) - Italia

Tel. +39 0544 977071- Fax +39 0544.971746

event@selecthotels.it - [www.bataniselecthotels.it](http://www.bataniselecthotels.it)